

.100"(2.54mm) pitch single row headers



CW2543 Series

- * Poles: 2-18
- * Material: Insulator: PBT UL94V-0 BLACK
- * Contact: 0.64mm(.025") square pin, brass, gold plated
- * Mates with CH2543 series housing

Specifications

- * Current rating: 2.5A AC, DC
- * Voltage rating: 250V AC, DC
- * Temperature range: -25°C~+85°C
- * Insulation resistance: 1,000MΩ min.
- * Withstand voltage: 600 AC/minute
- * Applicable PC board thickness: .063" (1.6mm)

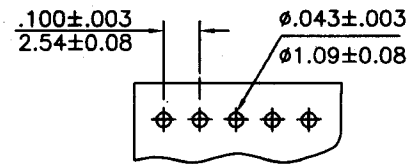

P.C. Board Layout

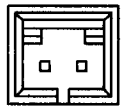

(2P)

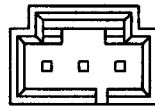

(3P)

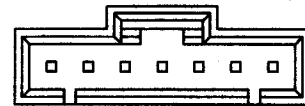

(4~18P)

P/N: CW2543S-XXG

inches
mm

P/N: CW2543R-XXG

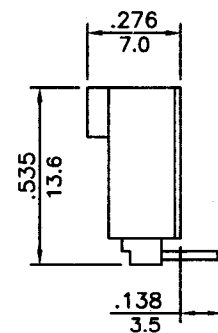
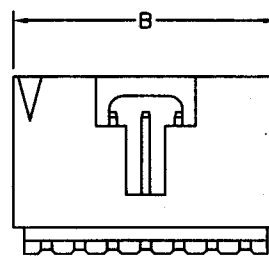
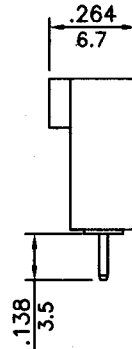
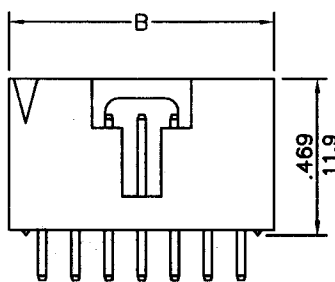
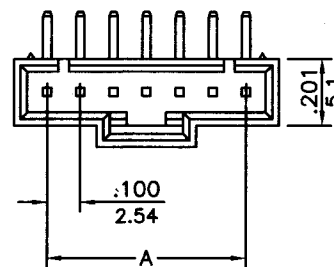
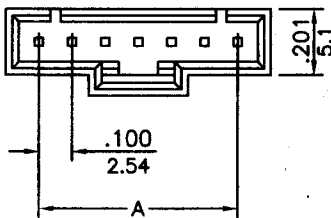

CIRCUITS	PART NO.	DIMENSION in.(mm)		CIRCUITS	PART NO.	DIMENSION in.(mm)	
		A	B			A	B
2	CW2543X-02G	0.100(2.54)	0.300(7.62)	11	CW2543X-11G	1.000(25.40)	1.200(30.48)
3	CW2543X-03G	0.200(5.08)	0.400(10.16)	12	CW2543X-12G	1.100(27.94)	1.300(33.02)
4	CW2543X-04G	0.300(7.62)	0.500(12.70)	13	CW2543X-13G	1.200(30.48)	1.400(35.56)
5	CW2543X-05G	0.400(10.16)	0.600(15.24)	14	CW2543X-14G	1.300(33.02)	1.500(38.10)
6	CW2543X-06G	0.500(12.70)	0.700(17.78)	15	CW2543X-15G	1.400(35.56)	1.600(40.64)
7	CW2543X-07G	0.600(15.24)	0.800(20.32)	16	CW2543X-16G	1.500(38.10)	1.700(43.18)
8	CW2543X-08G	0.700(17.78)	0.900(22.86)	17	CW2543X-17G	1.600(40.64)	1.800(45.72)
9	CW2543X-09G	0.800(20.32)	1.000(25.40)	18	CW2543X-18G	1.700(43.18)	1.900(48.26)
10	CW2543X-10G	0.900(22.86)	1.100(27.94)				