

.098"(2.50mm) pitch Wire to Board Connectors

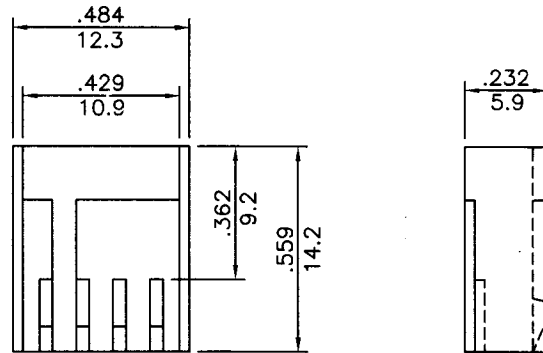

CH256-04 Series

- * Poles:4
 - * Material: NYLON 66 UL94V-2
 - * Suitable CT256T terminal
 - * Mates with CW256X-04 series wafer
- Specifications
- * Current rating: 3A AC, DC
 - * Voltage rating: 250V AC, DC
 - * Temperature range: -25°C~+85°C
 - * Insulation resistance: 1,000MΩ min.
 - * Withstand voltage: 800V AC/minute

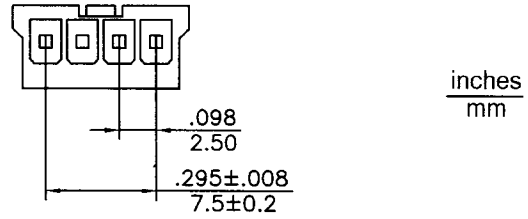

.098"(2.50mm) pitch connectors crimp terminal

CT256T Series

- * Material: Brass
- * Finished: Tin-plated
- * Used in CH256 series housings
- * Wire range: AWG#22~#26
- * Insulation O.D: 1.75mm(max)
- * Thickness: 0.2mm
- * Q'TY: 10,000pcs/reel

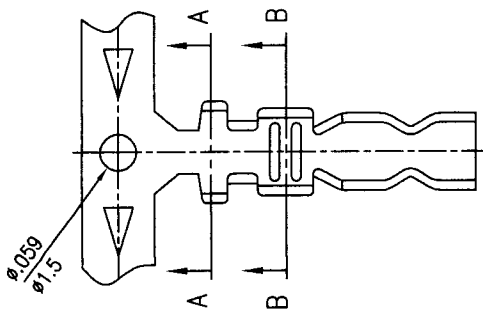

inches
mm

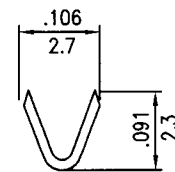

A-A SECTION

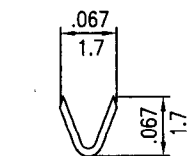
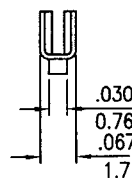
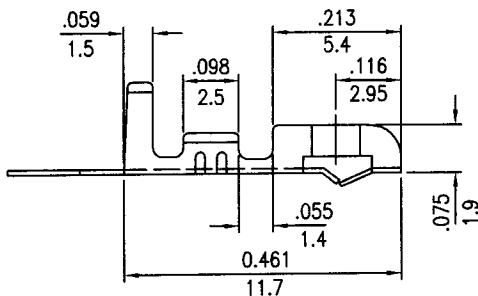

B-B SECTION