

.098"(2.50mm) pitch single row pin headers



CW2502 Series

- * Material: Insulator: NYLON UL 94V-0 Color Nature
- * Contact: 0.64mm(.025") square pin, brass, tin plated
- * Mates with CH2502-XX series housing

Specifications

- * Current rating: 3A AC, DC
- * Voltage rating: 250V AC, DC
- * Temperature range: -25°C~+85°C
- * Insulation resistance: 1,000MΩ min.
- * Withstand voltage: 800V AC/minute
- * Applicable PC board thickness: .063" (1.6mm)

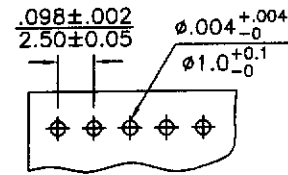

P.C. Board Layout

P/N: CW2502S-XX
Straight Angle

P/N: CW2502R-XX
Right Angle

inches
mm

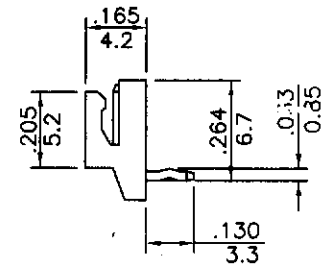
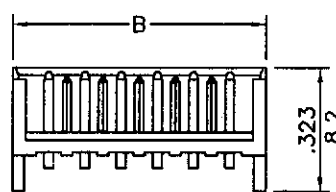
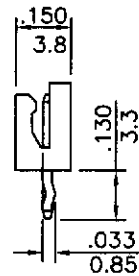
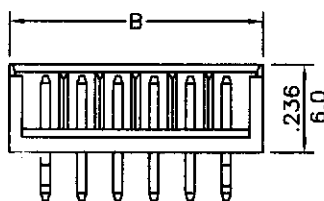
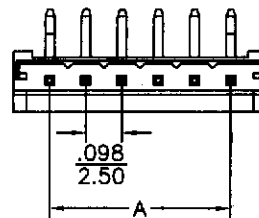
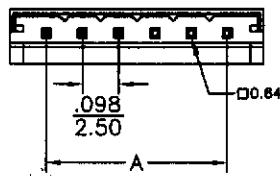

CIRCUITS	PART NO.	DIMENSION in.(mm)		CIRCUITS	PART NO.	DIMENSION in.(mm)	
		A	B			A	B
2	CW2502X-02	0.098(2.50)	0.295(7.5)	7	CW2502X-07	0.591(15.00)	0.787(20.0)
3	CW2502X-03	0.197(5.00)	0.394(10.0)	8	CW2502X-08	0.689(17.50)	0.886(22.5)
4	CW2502X-04	0.295(7.50)	0.492(12.5)	9	CW2502X-09	0.787(20.00)	0.984(25.0)
5	CW2502X-05	0.394(10.00)	0.591(15.0)	10	CW2502X-10	0.886(22.50)	1.083(27.5)
6	CW2502X-06	0.492(12.50)	0.689(17.5)	12	CW2502X-12	1.083(27.50)	1.280(32.5)